

# ColorLinx™ Closed Loop

***The Universal Solution for Press Side Color Management***

ColorLinx Closed Loop combines the benefits of digital ink key presetting with closed loop color control for most popular sheetfed press models. Reduce your makeready costs and add stability over long runs with a solution that extends the lifespan of your pressroom investment.

## How does it work?

ColorLinx Platinum is the full function color control system, comprised of a Keyset server in prepress, a ColorLinx computer and scanning spectrophotometer at press side.

The Keyset server receives CIP or PDF files from the prepress workflow and determines ink coverage for all press units, on all ink keys.

At press side, the ColorLinx system processes the Keyset file to automatically position the ink keys for each unit. Color is 95% accurate on the first pull. During production, ColorLinx is used with the scanning spectrophotometer to continually adjust the ink keys and maintain final color.

In addition to ink key presets and closed loop color control, ColorLinx offers value as a tool to refine your plant's printing process. ColorLinx Plate Manager utility provides dot gain information which can be used to manually adjust CTP calibration curves and correct for dot gain characteristics on press.

Statistical data saved from ColorLinx Closed Loop can provide opportunities to study your printing process in depth and advance towards greater productivity while maintaining a high standard of printing quality.

ColorLinx Closed Loop software is the right solution for printers who want to reduce makeready waste, achieve productivity and a competitive edge.

## ColorLinx is available in several editions

	Ink Key Preset	Closed Loop
<b>ColorLinx Platinum</b>	yes	yes
<b>ColorLinx Gold</b>	no	yes
<b>ColorLinx Silver</b>	yes	offline
<b>ColorLinx Bronze</b>	offline	offline

universal print control

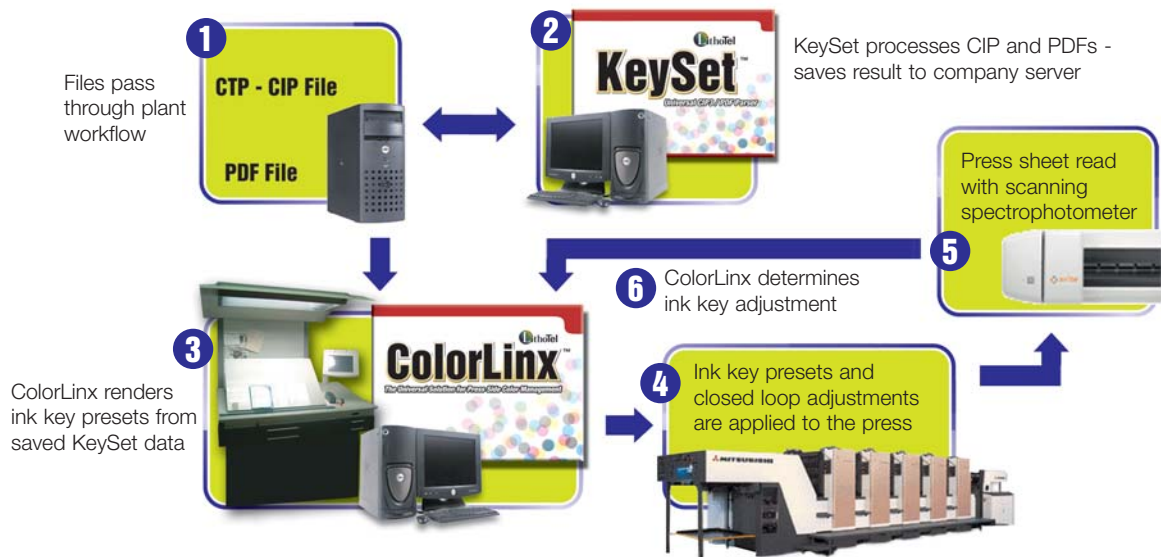

# ColorLinx™ Closed Loop

## SPECIFICATIONS

**Keyset** Processes 20MB CIP/PDF file in less than 1 second

### Preset

95% of KCMY densities on first pull, when properly calibrated

### Prepress Workflow

Must generate PDF or CIP v.2.1 (Prinerger, Delta, Rampage, etc)

### Press Console

Heidelberg 1.02 , 1.03, 1.04 & CP2000 with card reader  
MAN Roland with ChipDrive card reader\*  
Mitsubishi , Komori PQC , KBA, Perretta P2100

*\* For Preset use only, not for closed loop control*

Contact your LithoTel dealer for details

**Maximum number of printing units** 12

**Perfector** Any combination to a maximum of 12 units

**Single press environment** KeySet and ColorLinx may be installed on the same press side computer

**Multi press environment** KeySet is installed as a prepress server, ColorLinx workstations are installed press side

## COLORLINX EDITIONS

**ColorLinx Platinum** - Complete presetting and closed loop color control for Mitsubishi, Komori, Heidelberg, KBA, Perretta

**ColorLinx Gold** - Closed loop color control, no presetting capability (may be upgraded to Platinum package)  
Mitsubishi, Komori, Heidelberg, KBA, Perretta

**ColorLinx Silver** - Ink key presets with offline<sup>†</sup> color control for Mitsubishi, Komori, Roland, Heidelberg, KBA, Perretta

**ColorLinx Bronze** - A solution available for older presses unable to communicate with PC's, offering offline<sup>†</sup> versions of both ink key presets and color control for Mitsubishi, Komori, Roland, Heidelberg, KBA, Perretta and any other non-interfaced press console

*† Data will be graphically displayed allowing the press operator to manually match the keys to the recommended profile.*

## POWER REQUIREMENTS

**Minimum one power outlet** dedicated to ColorLinx Preset and independent of press power supply (ie: will not lose power when the press is turned off)

**UPS** 500 watt UPS system recommended

## NETWORK REQUIREMENTS

**Customer is required to have network drops in all appropriate locations prior to the installation for all press side and server systems.**

**Network Administrator** Assistance from the network administrator is required to create user profiles/permissions, join the new computers to the network and to configure the shared folders for the CIP/PDF and Preset Files.

## SUPPLIED WITH PURCHASE

- KeySet and ColorLinx Software
- Viewer Software
- All necessary cable extensions to properly position computer and monitor on the press console
- Monitor Stand and all mounting hardware
- Interface Kit for each press
- HASP security dongle for each computer installed

## Computer System

*The following is currently supplied/recommended for Colorlinx, please confirm details with your LithoTel dealer*

Supplier	Dell
Model	OptiPlex 330, Mini Tower
Processor	Dual Core 2.00GHZ, 1MB Cache
Power Supply	375W
Memory	1GB
Graphics Card	Integrated Video
Hard Drive	80GB
Operation System	WindowsXP
Optical Drive	48X CD-ROM Drive
Keyboard	USB English Keyboard
Mouse	USB Optical Mouse
USB Ports	6 USB Ports
Network Adapter	2 Gigabit Network Adapters
Serial Port	1 RS232 Serial Port
Service and Support	3 years Next Business Day On-Site Support

## Recommended Monitors

Dell 15-Inch Flat Panel Colour LCD Touchscreen Monitor (E157FPT)

**Installation and Training** One day installation and training included with purchase

## OPTIONAL UPGRADE PATH

To DynaLinx remote color OK system

## WARRANTY AND SUPPORT

All LithoTel softwares are warrantied from defects for 90 days. Additional support packages available, contact LithoTel Software for details.

Pre-sales Support	1-800-852-0236
Technical Support Line	905-668-3786
Email Support	support@lithotel.ca
Web	www.lithotel.ca

## LithoTel Software Design Ltd

214 Dundas Street East Whitby ON Canada L1N 2H8  
T 905 668-3786 F 905 666-4523 TF 800 852 0236



Specifications and terms are subject to change without notice. ColorLinx and Keyset are registered trademarks of LithoTel Software Design Ltd. All other product and brand names are trademarks and/or registered trademarks of their respective companies.